



FA LF55 SERIES

4 X 2 RIGID

Engine: 185/220hp
Tyres: CE 5.9 litres
G.V.W. GB: 18 tonnes
Plated Front: 7100 kg
Plated Rear: 11500 kg
G.C.M. GB: 21.5 tonnes



	Wheelbase - AE		Chassis and Cab Weights			Gross Carrying Capacity			Variable Dimensions							
	W/B	AE ⁴	Front	Rear	Total	Front	Rear	Total	AC	CB	CH	BL ⁵	TL	HA ¹	HA ²	
Day cab	3.45	1.14	3120	1830	4950	3980	9670	13050	.23	.12	1.89	4.13	4.44	5.97	1.10	.95
	3.45	1.48	3100	1860	4960	4000	9640	13040	.23	.12	1.89	4.11	4.43	6.31	1.10	.95
	3.75	1.14	3120	1840	4960	3980	9660	13040	.23	.12	1.89	4.54	4.89	6.27	1.10	.95
	3.75	1.63	3100	1870	4970	4000	9630	13030	.23	.12	1.89	4.53	4.88	6.76	1.10	.95
	4.15	1.14	3130	1870	5000	3970	9630	13000	.23	.12	1.89	5.10	5.49	6.67	1.10	.95
	4.15	1.83	3110	1900	5010	3990	9600	12990	.23	.12	1.89	5.09	5.47	7.36	1.10	.95
	4.45	1.98	3120	1980	5100	3980	9520	12900	.23	.12	1.89	5.49	5.91	7.81	1.10	.95
	4.75	2.13	3130	2000	5130	3970	9500	12870	.23	.12	1.89	5.91	6.36	8.26	1.10	.95
	5.30	2.40	3140	2100	5240	3960	9400	12760	.23	.12	1.89	6.66	7.16	9.08	1.10	.95
	5.85	2.68	3140	2150	5290	3960	9350	12710	.23	.12	1.89	7.41	7.96	9.91	1.10	.95
6.25	2.88	3150	2180	5330	3950	9320	12670	.23	.12	1.89	7.96	8.55	10.51	1.10	.95	
Sleeper Cab	3.45	1.48	3250	1860	5110	3850	9640	12890	.63	.07	1.89	3.47	3.79	6.31	1.10	.95
	3.75	1.63	3250	1870	5120	3850	9630	12880	.63	.07	1.89	3.89	4.24	6.76	1.10	.95
	4.15	1.83	3260	1900	5160	3840	9600	12840	.63	.07	1.89	4.45	4.84	7.36	1.10	.95
	4.45	1.98	3270	1980	5250	3830	9520	12750	.63	.07	1.89	4.87	5.29	7.81	1.10	.95
	4.75	2.13	3280	2000	5280	3820	9500	12720	.63	.07	1.89	5.29	5.74	8.26	1.10	.95
	5.30	2.40	3290	2100	5390	3810	9400	12610	.63	.07	1.89	6.04	6.55	9.08	1.10	.95
	5.85	2.68	3290	2150	5440	3810	9350	12560	.63	.07	1.89	6.80	7.37	9.91	1.10	.95
6.25	2.88	3300	2180	5480	3800	9320	12520	.63	.07	1.89	7.36	7.96	10.51	1.10	.95	

Fixed dimensions VA: 1.38 HV: ³.91 RB: .79 SB: 1.81 TB: 2.44

Chassis and Cab Weight calculated with: Standard specification items only with full tank of fuel, 200 litres.
 Front axle can be plated at 7500kg with appropriate tyres
 For TIPPER/SKIP applications driveline ratio's MUST be considered. Consult Sales Engineering.
THIS SPECIFICATION SHEET IS FOR PROVISIONAL PURPOSES ONLY!

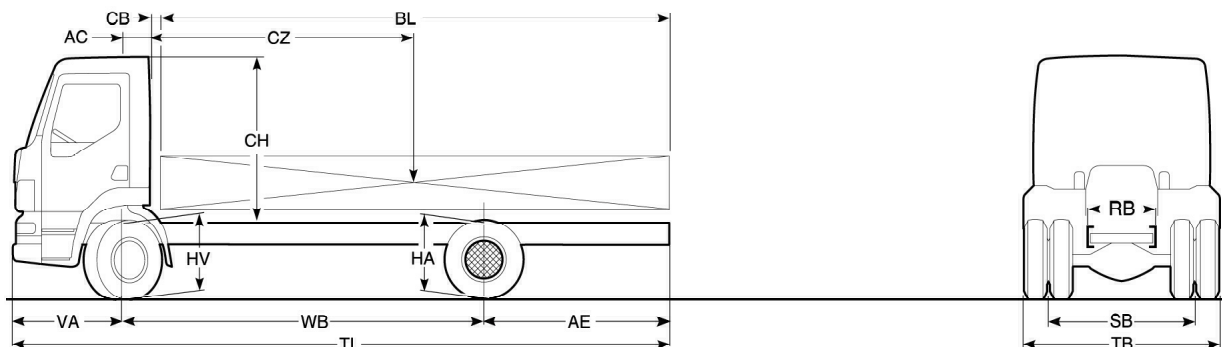

- 1) Unladen height over centre of rear axle.
- 2) Laden height over centre of rear axle.
- 3) Laden height over centre of front axle.

- 4) 1.14m AE are with Tipper springs and 0.66m AE are with Refuse springs.
- 5) For Tipper body lengths (1.14m AE) consult TOPEC.

Cab - Exterior

LF steel day cab with hydraulic tilt mechanism
Aerodynamic design
Bonded laminated windscreen
Illuminated steps
Steel front bumper
Standard equipment includes:
Rear window clear glass
Corner air deflectors
Cab prepared for roof spoiler fitment
2 x Electrically heated rear view mirrors a wide angle and kerb mirror for bodies 2.5m-2.6m wide
5 year corrosion warranty*
2 year paint warranty*
* Subject to terms and conditions

Cab - Interior

Ergonomic aesthetically designed cab interior
Cruise control
Driver and co-driver high back single rigid seats with seat belts
Phone prepared (aerial and 12 volt connections)
Driver and co-driver electrically operated windows
Storage on engine tunnel, above windscreen, on the dash and cab rear wall
Wrap round easy-clean dashboard
Multi-functional Digital Information Panel (DIP)
Exhaust brake (column controlled throttle off)
RSL set at 85kmh
Adjustable steering column
24/12 volt converter of 15 Amp capacity

Suspension

Front axle:
Steel maintenance free parabolic springs with shock absorbers and anti-roll bar

Rear axle:
Steel maintenance free parabolic springs with shock absorbers and anti-roll bar

Front axle:
DAF 152N "I" section rigid beam
Design gross 7500kg

Rear axle:
DAF SR11.26 single reduction drive axle
Design gross 11500kg

Wheels and Tyres

Front axle 8.25 x 22.5 10 stud wheels with 295/80R22.5 tyres with highway tread

Rear axle 8.25 x 22.5 10 stud wheels with 295/80R22.5 tyres with traction tread

Engine

PACCAR 5.9 litre Euro 3
Electronically controlled engine with common rail injection system
Max power 185/220hp (136/162kW) at 2500 rpm
Max torque 700/820Nm at 1200-1700 rpm

Gearbox

Type: ZF 6S850 six speed gearbox
Gear ratios:
1st 6.72:1 Top 0.79:1 Reverse 6.03:1

Clutch

Single dry plate clutch 395mm diameter.

Performance

	Rear axle ratio	Governed engine speed	Max geared geared speed	Max. restart restart gradient
180hp	5.71:1	2500	66	27%*
220hp	5.71:1	2500	66	30%+*

*Gradeability may be limited by tyre adhesion.

Brake System

DAF full air disc brakes all round including ABS.
225cc compressor delivering 330 l/min
Heated air processing unit and exhaust brake.

Frame

Completely flat topped frame of riveted and bolted construction and body attachment mountings.

Chassis member dimensions 260mm x 75mm x 6mm

Chassis width rear: 790mm

Bumper: steel construction

Front towing facility: chassis located x 2

Steering

Hydraulic power assisted with a 50 degree lock angle.

Turning circle kerb-kerb (wall-wall)				
3.45m WB	12.20m	(13.50m)	4.75m WB	15.20m (16.90m)
3.75m WB	12.70m	(14.30m)	5.30m WB	16.60m (18.30m)
4.15m WB	13.70m	(15.30m)	5.85m WB	18.10m (19.70m)
4.45m WB	14.50m	(16.10m)	6.25m WB	19.10m (20.70m)

Electrical Equipment

Fully coded 24 volt CAN based system and hard wiring

80 Amp alternator

2 x 125 Ah deep cycle batteries

Rear light cluster includes:

rearlights, stop lights, indicators, reverse and fog lights, and reflectors

Provision for side and end marker lamps.

General Equipment

Cab rear window

Single 200 litre steel fuel tank

Cruise control

Single high back seats with seat belts

7100 kg front axle (7500kg design)

Exhaust brake (throttle off)

Lockable fuel cap

Front axle spray suppression

Silver wheels

Cab tilt bar and wheelbrace.

Optional Equipment

Hazard beacons

Driver air bag (N/A until late 2001)

Driver air or luxury seat

Co-driver dual or luxury dual

Audio equipment

CB preparation

Central door locking with remote control

Heated front windscreen

Air conditioning

ECAS rear air suspension

170 Ah batteries

Diff lock

Front PTO facility

Various fuel tanks

Drawbar package

Tipper package

Sleeper cab:

Appointment as per day cab but includes: 3 large underbunk storage compartments
2m long single piece bed and provision for optional night heater.

The availability and specification of this vehicle may differ per country.

For further information please contact the DAF organisation.

Subject to modification without prior notice