



FA LF55 SERIES

4 X 2 RIGID

Engine: 170/180/220hp
BE 3.9/CE 5.9 litre
Tyres: 285/70R19.5
G.V.W. GB: 15 tonnes
Plated Front: 5600 kg
Plated Rear: 10500 kg
G.C.M. GB: 18.5 tonnes



	Wheelbase - AE		Chassis and Cab Weights			Gross Carrying Capacity			Variable Dimensions							
	W/B	AE	Front	Rear	Total	Front	Rear	Total	AC	CB ⁵	CH	BL ⁴	TL	HA ¹	HA ²	
Day cab	3.25	1.70	2770	1270	4040	2830	9230	10960	.28	.12	1.89	4.06	4.71	6.28	1.02	.91
	3.50	1.85	2760	1340	4100	2840	9160	10900	.28	.12	1.89	4.41	5.13	6.68	1.02	.91
	3.80	2.03	2770	1380	4150	2830	9120	10850	.28	.12	1.89	4.86	5.64	7.16	1.02	.91
	4.20	2.27	2770	1460	4230	2830	9040	10770	.28	.12	1.89	5.44	6.30	7.80	1.02	.91
	4.50	2.45	2770	1470	4240	2830	9030	10760	.28	.12	1.89	5.88	6.81	8.28	1.02	.91
	4.80	2.63	2780	1480	4260	2820	9020	10740	.28	.12	1.89	6.33	7.32	8.76	1.02	.91
	5.35	2.96	2780	1530	4310	2820	8970	10690	.28	.12	1.89	7.14	8.25	9.64	1.02	.91
	5.90	3.29	2790	1550	4340	2810	8950	10660	.28	.12	1.89	7.96	9.18	10.52	1.02	.91
	6.30	3.53	2800	1570	4370	2800	8930	10630	.28	.12	1.89	8.55	9.87	11.16	1.02	.91
Sleeper Cab	3.25	1.70	2920	1270	4190	2680	9230	10810	.68	.07	1.89	3.42	4.09	6.28	1.02	.91
	3.50	1.85	2910	1340	4250	2690	9160	10750	.68	.07	1.89	3.79	4.51	6.68	1.02	.91
	3.80	2.03	2910	1380	4290	2690	9120	10710	.68	.07	1.89	4.23	5.02	7.16	1.02	.91
	4.20	2.27	2920	1460	4380	2680	9040	10620	.68	.07	1.89	4.83	5.70	7.80	1.02	.91
	4.50	2.45	2920	1470	4390	2680	9030	10610	.68	.07	1.89	5.28	6.22	8.28	1.02	.91
	4.80	2.63	2930	1480	4410	2670	9020	10590	.68	.07	1.89	5.73	6.74	8.76	1.02	.91
	5.35	2.96	2930	1530	4460	2670	8970	10540	.68	.07	1.89	6.55	7.68	9.64	1.02	.91
	5.90	3.29	2940	1550	4490	2660	8950	10510	.68	.07	1.89	7.38	8.63	10.52	1.02	.91
	6.30	3.53	2950	1570	4520	2650	8930	10480	.68	.07	1.89	7.99	9.32	11.16	1.02	.91

Fixed dimensions VA: 1.33 HV: ³.83 RB: .79 SB: 1.73 TB: 2.35

Chassis and Cab Weight calculated with: Standard specification items only with full tank of fuel, based on a 180hp model.

NOTE: For 170hp -120kg (engine) from the front axle.

THIS SPECIFICATION SHEET IS FOR PROVISIONAL PURPOSES ONLY!

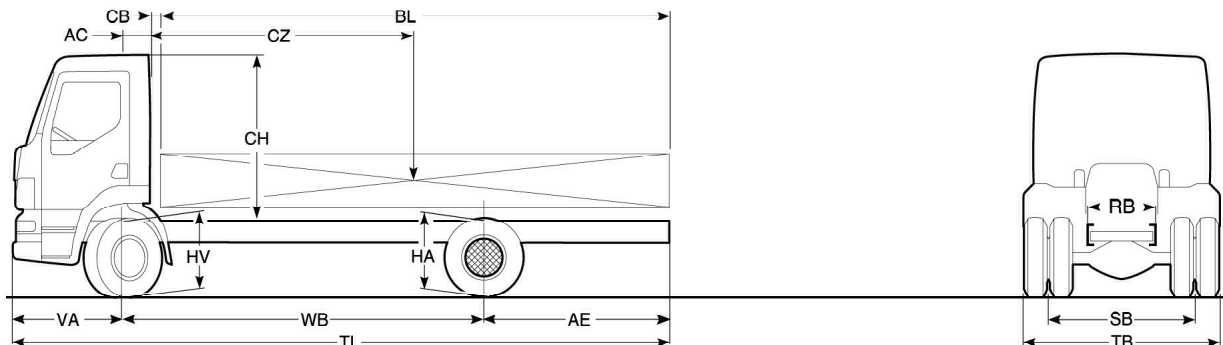

- 1) Unladen height over centre of rear axle.
- 2) Laden height over centre of rear axle.
- 3) Laden height over centre of front axle.

- 4) For specific Body lengths consult TOPEC
- 5) CB dimension for 170hp day cab is 0.07m (7cm).

Cab - Exterior

LF steel day cab with hydraulic tilt mechanism
Aerodynamic design
Bonded laminated windscreen
Illuminated steps
Steel front bumper
Standard equipment includes:
Rear window clear glass
Corner air deflectors
Cab prepared for roof spoiler fitment
2 x Electrically heated rear view mirrors a wide angle and kerb mirror for bodies 2.5m-2.6m wide
5 year corrosion warranty*
2 year paint warranty*
* Subject to terms and conditions

Cab - Interior

Ergonomic aesthetically designed cab interior
Cruise control
Driver and co-driver high back single rigid seats with seat belts
Phone prepared (aerial and 12 volt connections)
Driver and co-driver electrically operated windows
Storage on engine tunnel, above windscreen, on the dash and cab rear wall
Wrap round easy-clean dashboard
Multi-functional Digital Information Panel (DIP)
Exhaust brake (column controlled throttle off)
RSL set at 85kmh
Adjustable steering column
24/12 volt converter of 15 Amp capacity

Suspension

Front axle:
Steel maintenance free parabolic spring with shock absorbers and anti-roll bar

Rear axle:
Steel maintenance free parabolic spring with shock absorbers and anti-roll bar

Front axle:
DAF F60 "I" section rigid beam
Design gross 6000kg

Rear axle:
DAF SR10.20 single reduction drive axle
Design gross 10500kg

Wheels and Tyres

Front axle 7.50 x 19.5 8 stud wheels with 285/70R19.5 tyres with highway tread

Rear axle 7.50 x 19.5 8 stud wheels with 285/70R19.5 tyres with traction tread

Engine

PACCAR 3.9 and *5.9 litre Euro 3
Electronically controlled engine with common rail injection system
Max power 167hp (123kW) at 2500 rpm
*185/220hp (136/162kW) at 2500 rpm

Max torque 600Nm at 1200-1600 rpm
*700/820Nm at 1200-1700 rpm

Gearbox

Type: ZF 6S850 six speed gearbox
Gear ratios:
1st 6.72:1 Top 0.79:1 Reverse 6.03:1

Clutch

Single dry plate clutch 362mm diameter. 4 cylinder engine
Single dry plate clutch 395mm diameter. 6 cylinder engine

Performance

	Rear axle ratio	Governed engine speed rpm	Max geared speed mph	Max. restart gradient
170hp	4.56:1	2500	71	27%*
180hp	4.56:1	2500	71	30%+*
220hp	4.56:1	2500	71	30%+*

*Gradeability may be limited by tyre adhesion.

Brake System

DAF full air disc brakes all round including ABS.
225cc compressor delivering 330 l/min
Heated air processing unit and exhaust brake.

Frame

Completely flat topped frame of riveted and bolted construction and body attachment mountings.

Chassis member dimensions 260mm x 75mm x 6mm
Chassis width rear: 790mm
Bumper: steel construction
Front towing facility: chassis located x 2

Steering

Hydraulic power assisted with a 52 degree lock angle.

Turning circle kerb-kerb (wall-wall)				
3.25m WB	11.10m	(12.60m)	4.80m WB	14.80m (16.50m)
3.50m WB	11.70m	(13.20m)	5.35m WB	16.30m (17.90m)
3.80m WB	12.40m	(14.00m)	5.90m WB	17.60m (19.30m)
4.20m WB	13.40m	(15.00m)	6.30m WB	18.60m (20.30m)
4.50m WB	14.10m	(15.80m)		

Electrical Equipment

Fully coded 24 volt CAN based system and hard wiring
80 Amp alternator
2 x 125 Ah deep cycle batteries
Rear light cluster includes:
rearlights, stop lights, indicators, reverse and fog lights, and reflectors
Provision for side and end marker lamps.

General Equipment

Cab rear window
Single 150 litre steel fuel tank
Cruise control
Single high back seats with seat belts
Exhaust brake
Front axle spray suppression
Lockable fuel cap
Silver wheels
Cab tilt bar and wheelbrace

Optional Equipment

Hazard beacons
Driver air bag (N/A until late 2001)
Driver air or luxury seat
Co-driver dual or luxury dual
Audio equipment
CB preparation
Central door locking with remote control
Heated front windscreen
Air conditioning
ECAS rear air suspension
170 Ah batteries
Diff lock
Front PTO facility
Various fuel tanks
Drawbar package
Tipper package

Sleeper cab:
Appointment as per day cab but includes: 3 large underbunk storage compartments
2m long single piece bed and provision for optional night heater.

The availability and specification of this vehicle may differ per country.
For further information please contact the DAF organisation.

Subject to modification without prior notice