



FA LF55 SERIES

4 X 2 RIGID

Engine: 170/180/220hp
BE 3.9/CE 5.9 litre
Tyres: 265/70R19.5
G.V.W. GB: 13 tonnes
Plated Front: 5000 kg
Plated Rear: 9440 kg
G.C.M. GB: 16.5 tonnes



	Wheelbase - AE		Chassis and Cab Weights			Gross Carrying Capacity			Variable Dimensions							
	W/B	AE	Front	Rear	Total	Front	Rear	Total	AC	CB ⁵	CH	BL ⁴	TL	HA ¹	HA ²	
Day cab	3.25	1.70	2760	1250	4010	2240	8190	8990	.28	.12	1.89	4.12	5.17	6.28	1.01	.91
	3.50	1.85	2750	1320	4070	2250	8120	8930	.28	.12	1.89	4.48	5.62	6.68	1.01	.91
	3.80	2.03	2750	1360	4110	2250	8080	8890	.28	.12	1.89	4.93	6.17	7.16	1.01	.91
	4.20	2.27	2760	1440	4200	2240	8000	8800	.28	.12	1.89	5.52	6.91	7.80	1.01	.91
	4.50	2.45	2760	1450	4210	2240	7990	8790	.28	.12	1.89	5.97	7.46	8.28	1.01	.91
	4.80	2.63	2770	1460	4230	2230	7980	8770	.28	.12	1.89	6.42	8.02	8.76	1.01	.91
	5.35	2.96	2770	1510	4280	2230	7930	8720	.28	.12	1.89	7.24	9.02	9.64	1.01	.91
	5.90	3.29	2780	1530	4310	2220	7910	8690	.28	.12	1.89	8.07	10.04	10.52	1.01	.91
	6.30	3.53	2790	1550	4340	2210	7890	8660	.28	.12	1.89	8.67	10.79	11.16	1.01	.91
Sleeper Cab	3.25	1.70	2910	1250	4160	2090	8190	8840	.68	.07	1.89	3.51	4.58	6.28	1.01	.91
	3.50	1.85	2900	1320	4220	2100	8120	8780	.68	.07	1.89	3.87	5.03	6.68	1.01	.91
	3.80	2.03	2900	1360	4260	2100	8080	8740	.68	.07	1.89	4.33	5.59	7.16	1.01	.91
	4.20	2.27	2910	1440	4350	2090	8000	8650	.68	.07	1.89	4.93	6.34	7.80	1.01	.91
	4.50	2.45	2910	1450	4360	2090	7990	8640	.68	.07	1.89	5.39	6.90	8.28	1.01	.91
	4.80	2.63	2920	1460	4380	2080	7980	8620	.68	.07	1.89	5.85	7.47	8.76	1.01	.91
	5.35	2.96	2920	1510	4430	2080	7930	8570	.68	.07	1.89	6.68	8.49	9.64	1.01	.91
	5.90	3.29	2930	1530	4460	2070	7910	8540	.68	.07	1.89	7.52	9.53	10.52	1.01	.91
	6.30	3.53	2940	1550	4490	2060	7890	8510	.68	.07	1.89	8.14	10.29	11.16	1.01	.91

Fixed dimensions VA: 1.33 HV: ³.84 RB: .79 SB: 1.73 TB: 2.35

Chassis and Cab Weight calculated with: Standard specification items only with full tank of fuel, based on a 180hp model.

NOTE: For 170hp -120kg (engine) from the front axle.

THIS SPECIFICATION SHEET IS FOR PROVISIONAL PURPOSES ONLY!

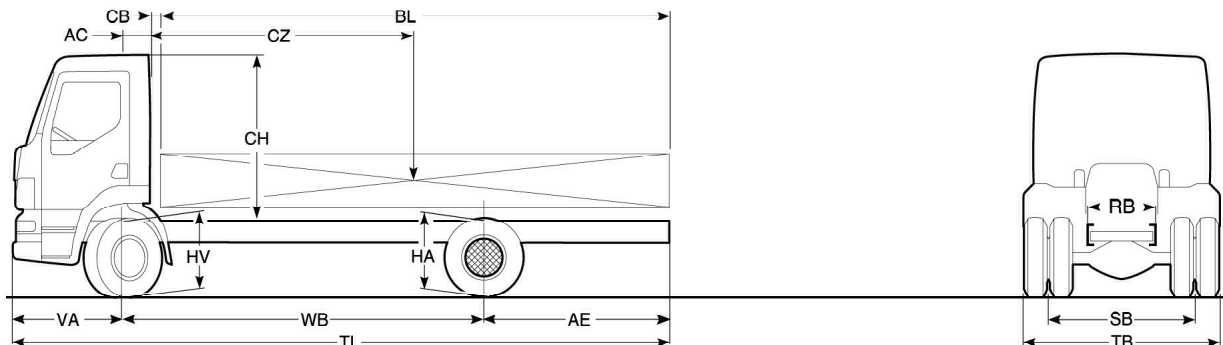

- 1) Unladen height over centre of rear axle.
- 2) Laden height over centre of rear axle.
- 3) Laden height over centre of front axle.

- 4) For specific Body lengths consult TOPEC
- 5) CB dimension for 170hp day cab is 0.07m (7cm).

Cab - Exterior

LF steel day cab with hydraulic tilt mechanism
Aerodynamic design
Bonded laminated windscreen
Illuminated steps
Steel front bumper
Standard equipment includes:
Rear window clear glass
Corner air deflectors
Cab prepared for roof spoiler fitment
2 x Electrically heated rear view mirrors a wide angle and kerb mirror for bodies 2.5m-2.6m wide
5 year corrosion warranty*
2 year paint warranty*
* Subject to terms and conditions

Cab - Interior

Ergonomic aesthetically designed cab interior
Cruise control
Driver and co-driver high back single rigid seats with seat belts
Phone prepared (aerial and 12 volt connections)
Driver and co-driver electrically operated windows
Storage on engine tunnel, above windscreen, on the dash and cab rear wall
Wrap round easy-clean dashboard
Multi-functional Digital Information Panel (DIP)
Exhaust brake (column controlled throttle off)
RSL set at 85kmh
Adjustable steering column
24/12 volt converter of 15 Amp capacity

Suspension

Front axle:
Steel maintenance free parabolic spring with shock absorbers and anti-roll bar

Rear axle:
Steel maintenance free parabolic spring with shock absorbers and anti-roll bar

Front axle:
DAF F60 "I" section rigid beam
Design gross 6000kg

Rear axle:
DAF SR10.20 single reduction drive axle
Design gross 10500kg

Wheels and Tyres

Front axle 7.50 x 19.5 8 stud wheels with 265/70R19.5 tyres with highway tread

Rear axle 7.50 x 19.5 8 stud wheels with 265/70R19.5 tyres with traction tread

Engine

PACCAR 3.9 and *5.9 litre Euro 3
Electronically controlled engine with common rail injection system
Max power 167hp (123kW) at 2500 rpm
*185/220hp (136/162kW) at 2500 rpm

Max torque 600Nm at 1200-1600 rpm
*700/820Nm at 1200-1700 rpm

Gearbox

Type: ZF 6S850 six speed gearbox
Gear ratios:
1st 6.72:1 Top 0.79:1 Reverse 6.03:1

Clutch

Single dry plate clutch 362mm diameter. 4 cylinder engine
Single dry plate clutch 395mm diameter. 6 cylinder engine

Performance

	Rear axle ratio	Governed engine speed rpm	Max geared speed mph	Max. restart gradient
170hp	4.56:1	2500	68	30%+*
180hp	4.56:1	2500	68	30%+*
220hp	4.56:1	2500	68	30%+*

*Gradeability may be limited by tyre adhesion.

Brake System

DAF full air disc brakes all round including ABS.
225cc compressor delivering 330 l/min
Heated air processing unit and exhaust brake.

Frame

Completely flat topped frame of riveted and bolted construction and body attachment mountings.

Chassis member dimensions 260mm x 75mm x 6mm
Chassis width rear: 790mm
Bumper: steel construction
Front towing facility: chassis located x 2

Steering

Hydraulic power assisted with a 52 degree lock angle.

Turning circle kerb-kerb (wall-wall)				
3.25m WB	11.10m	(12.60m)	4.80m WB	14.80m (16.50m)
3.50m WB	11.70m	(13.20m)	5.35m WB	16.30m (17.90m)
3.80m WB	12.40m	(14.00m)	5.90m WB	17.60m (19.30m)
4.20m WB	13.40m	(15.00m)	6.30m WB	18.60m (20.30m)
4.50m WB	14.10m	(15.80m)		

Electrical Equipment

Fully coded 24 volt CAN based system and hard wiring
80 Amp alternator
2 x 125 Ah deep cycle batteries
Rear light cluster includes:
rearlights, stop lights, indicators, reverse and fog lights, and reflectors
Provision for side and end marker lamps.

General Equipment

Cab rear window
Single 150 litre steel fuel tank
Cruise control
Single high back seats with seat belts
Exhaust brake
Front axle spray suppression
Lockable fuel cap
Silver wheels
Cab tilt bar and wheelbrace

Optional Equipment

Hazard beacons
Driver air bag (N/A until late 2001)
Driver air or luxury seat
Co-driver dual or luxury dual
Audio equipment
CB preparation
Central door locking with remote control
Heated front windscreen
Air conditioning
ECAS rear air suspension
170 Ah batteries
Diff lock
Front PTO facility
Various fuel tanks
Drawbar package
Tipper package

Sleeper cab:
Appointment as per day cab but includes: 3 large underbunk storage compartments
2m long single piece bed and provision for optional night heater.

The availability and specification of this vehicle may differ per country.
For further information please contact the DAF organisation.

Subject to modification without prior notice